



Date: 22/12/2021 **Author:** Ali Fayad **Project:** 319 Cleveland Street, Surry Hills NSW 2016
Client: Silver Water Plumbing **Contact:** Rocio **Contact Number:** 02 9099 5759
Plan #: RO.TW01.21 **PWZTMP #:** 1011477

Comments:

This plan has been designed by Ali Fayad of Sydney Traffic Control in accordance with Australian Standards outlined in the RMS's Traffic Control on Worksites Handbook. The plan is designed for the Road opening at the back of property 319 Cleveland Street, Surry Hills. Certified traffic controllers will be on site to implement and monitor this TCP. If you have any questions please contact Ali Fayad on 8068-1844 or 0451 153 044.

**ROAD MUST be Reinstated
 BACK TO Normal Conditions after
 Work hours and blocked off during Work hours
 to ensure the
 Safety of Pedestrians**

**Traffic Controller/Spotter
 must be in attendance
 at all times during and after
 Work hours**

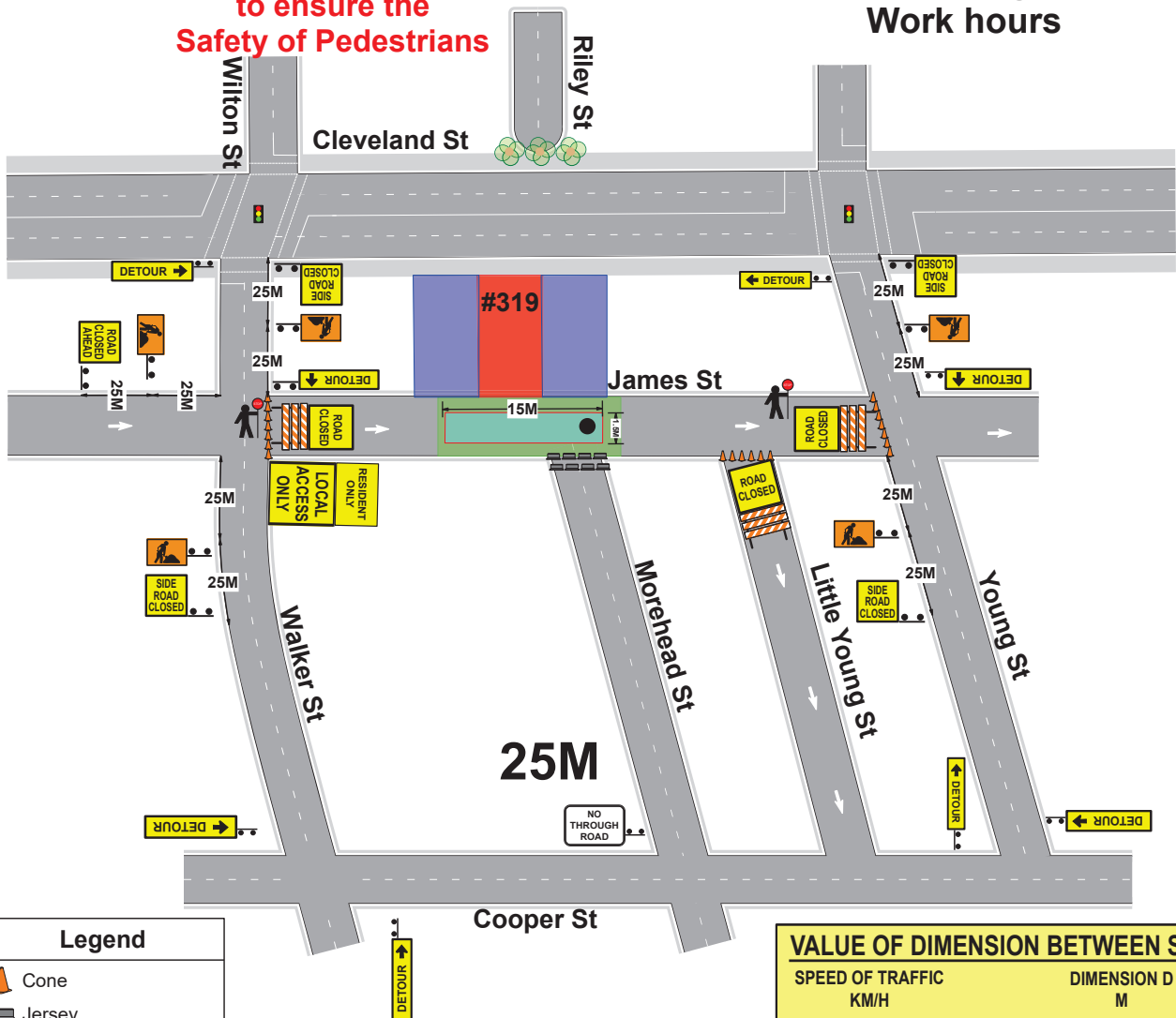

Legend

- Cone
- Jersey
- Man Hole
- Resident Only
- Road opening Location
- sign single
- Site Location
- Surrounding Property's
- Traffic Controller
- Tree
- Work Area

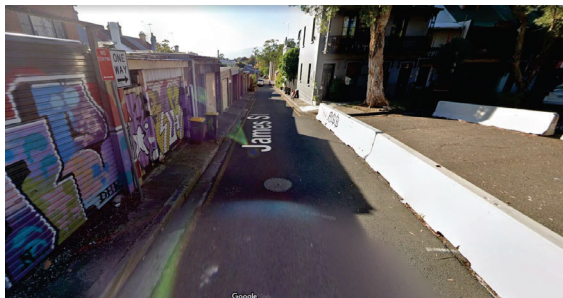

VALUE OF DIMENSION BETWEEN SIGNS

SPEED OF TRAFFIC KM/H	DIMENSION D M
45 or less	0 to 5
46 to 55	15
56 to 65	45
Greater than 65	Equal to speed of traffic, in km/h

RECOMMENDED TAPER LENGTH (m)

SPEED OF TRAFFIC KM/H	TRAFFIC CONTROL AT THE BEGINNING OF THE TAPER
45 or less	15
46 to 55	15
56 to 65	30
Greater than 65	N/A